

## 5kN Wedge Grip



### Description

This wedge grip is ideal for tensile testing below 5000N of flat and rigid materials including plastics, rubber and light metals. A spring-loaded lever ensures the serrated jaws are easy to open for fast loading and release of samples up to 25mm wide and 8mm thick. As load is applied the wedge action of the jaws ensures the sample is held rigidly without slippage.

### Applications

Used for general-purpose tensile testing of:

- adhesive joints
- cables
- composites
- crimp and welded joints
- metals
- plastics
- polymer
- rubber
- wood

### Specifications

Maximum Capacity	Maximum Specimen Dimensions		Weight	Length
	Width	Thickness		
5kN (500kgf, 1100lbf)	25mm (1.00")	8mm (0.314")	550g (1.21lbs)	80mm (3.15")

ACCESSORY PART NO. 432-398

## Dimensions mm (inch)

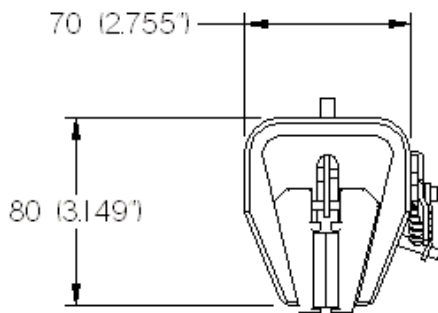

Front View

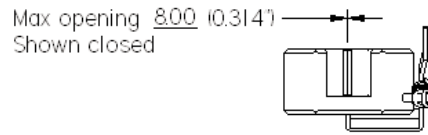

Top View

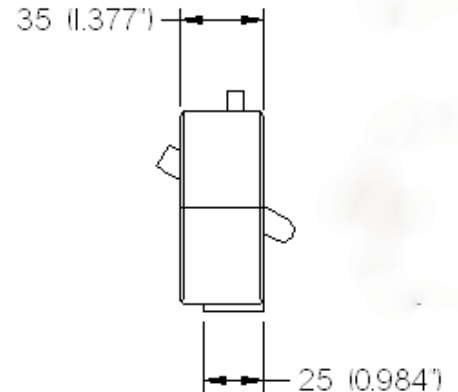

Side View

## Adaptors

To fit to:	Adaptor Type and (Part Number)**
<b>Loadcells</b>	
XLC-T / ILC-T 25kN	Not suitable
XLC-T / ILC-T 10kN, XLC-S / ILC-S 2500N, 5000N	432-331
XLC-S / ILC-S 1000N	432-333
XLC-S / ILC-S 100N, 200N, 500N	432-330
Force Gauge with 5/16 UNC Thread	None required
ILC / Force Gauge 10/32 UNF Thread	432-329
<b>Test Stands</b>	
MultiTest 10kN / 25kN	None required - fits to anvil plate
MultiTest 5kN	None required - fits to anvil plate
MultiTest 2.5kN	None required - fits to anvil plate
MultiTest 1kN	None required - fits to anvil plate

\*\* For further information please see Adaptor Datasheet 431-354-1-1



DISTRIBUTOR STAMP

431-354-26-1

Mecmesin reserves the right to alter equipment specifications without prior notice.

**Head Office**  
Mecmesin Limited  
Newton House, Spring  
Copse Business Park,  
Slinfold, West Sussex,  
RH13 0SZ, UK

e. sales@mecmesin.com  
t. +44 (0) 1403 799979  
f. +44 (0) 1403 799975

**North America**  
Mecmesin Corporation  
45921 Maries Road,  
Suite 120, Sterling  
Virginia 20166,  
U.S.A.

e. info@mecmesincorp.com  
t. +1 703 433 9247  
f. +1 703 444 9860

**Asia**  
Mecmesin Asia Co. Ltd  
91/1 Chaiyo Building, 11th Floor,  
Room 1106, Rama 9 Road, Huaykwang,  
Bangkok, 10310,  
Thailand

e. sales@mecmesinasia.com  
t. +66 2 247 46 81  
f. +66 2 247 46 82

**China**  
Mecmesin (Shanghai) Pte Ltd  
Room 302, No. 172,  
Daxue Lu - University Avenue,  
Yangpu District, Shanghai, 200433  
People's Republic of China

e. sales@mecmesin-china.com  
t. +86 21 5566 1037 / 3377 1738  
f. +86 21 5566 1057